

Memorandum

for the Engineering Committee Meeting of November 17, 2015

TO: Engineering Committee Members

FROM: Chip Close, Operations Manager
Shannon Matteoni, Business Services Technician

DATE: November 9, 2015

SUBJECT: Lodestar/Victoria Drive District Financed Waterline Extension

OPERATIONS

RECOMMENDATION: Review and evaluate the potential project using District Financed Waterline Extension policy criteria; advise staff as appropriate.

BACKGROUND: The District received a petition signed by eight (8) landowners, plus one (1) interested property owner verbally, to extend treated water from the corner of Lodestar/Conestoga east on Lodestar Drive continuing on Victoria Drive. This proposed project is contingent on the completion of the Lake of the Pines – Alta Sierra Waterline Backbone Extension Project, Phase 3.

The area has been mapped using the current policy methods. The project proposes approximately 3,400 lf of 8-inch pipe, potentially serving 14 parcels. The signed petition meets the 60 percent threshold.

As illustrated on the map, there are 14 mainline connections and no variance connections at this time. There appears to be two (2) vacant parcels. The policy outlines limiting vacant parcels to 20 percent which in this case is three (3).

BUDGETARY IMPACT: To be determined.

Attachments (1):

- Area Map

S:\arcview\WLE\LOdestarVictoria.mxd

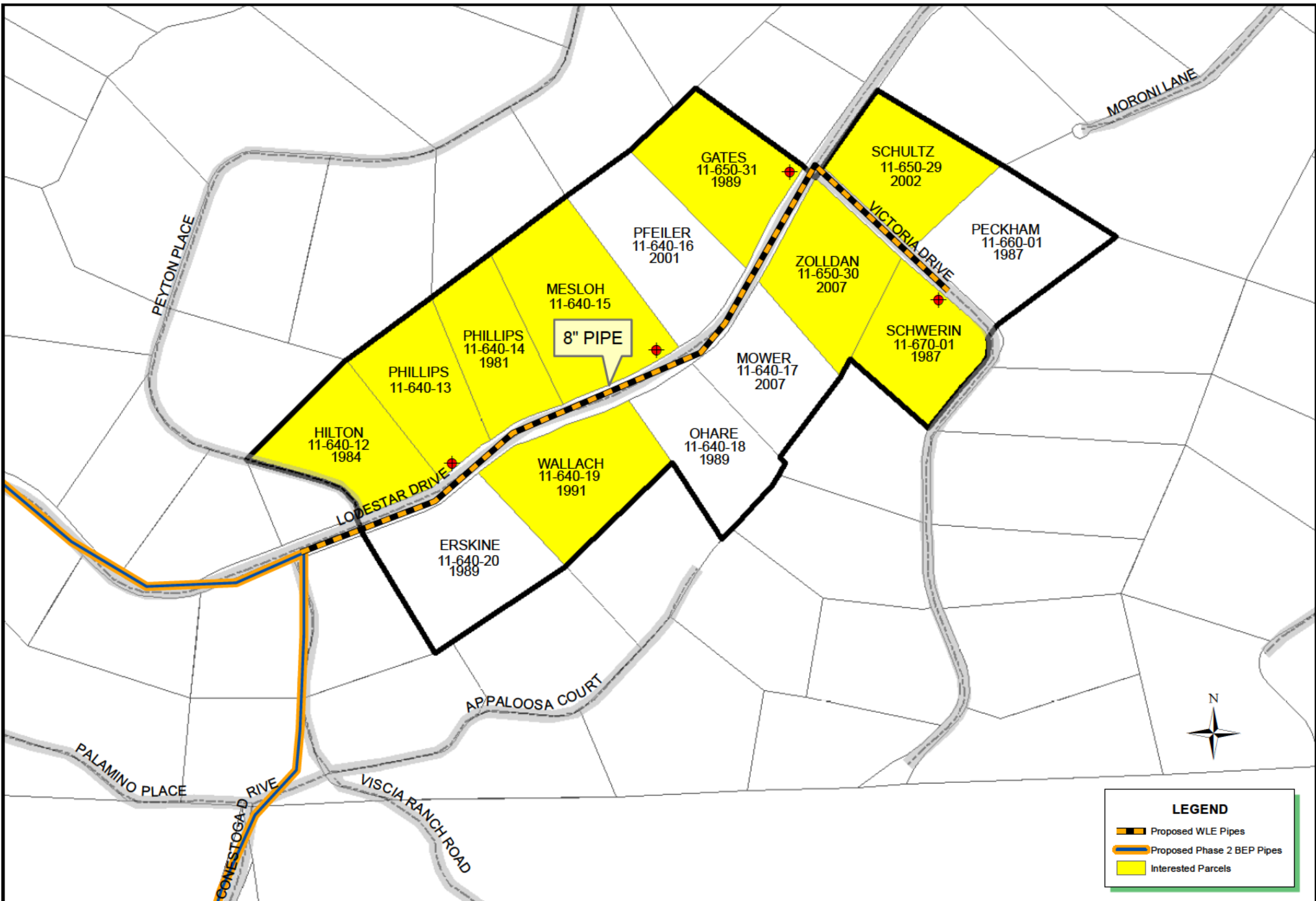

NEVADA IRRIGATION DISTRICT

NEVADA COUNTY – PLACER COUNTY
GRASS VALLEY, CALIFORNIA

LODESTAR VICTORIA DRIVE WATER LINE EXTENSION

Drawn By: D. HUNT

Date: 11/9/2015

Scale: 1" = 500' @ 8-1/2x11

Sheet: 1 of 1